



Eppendorf SmartBlock

Instructions for use

eppendorf



Copyright © 2012 Eppendorf AG, Hamburg. No part of this publication may be reproduced without the prior permission of the copyright owner.

Trademarks

eppendorf is a registered trademark of Eppendorf AG, Hamburg, Germany.

Trademarks are not marked in all cases with TM or [®] in this manual

1 Operating instructions

1.1 Using this manual

These instructions for use are a supplement to the operating manual of the ThermoMixer C and ThermoStat C devices. These instructions for use do not replace the operating manual.

Read the operating manual of the corresponding device before using the thermoblock for the first time. The current version of the operating manual can be found on our website at www.eppendorf.com.

2 Product description

2.1 Features

The thermoblocks (SmartBlocks) for the ThermoMixer C and ThermoStat C devices enable comfortable tempering and mixing of samples in lab vessels for the microliter and milliliter range.

Thermoblock	Tubes/Plates	Maximum mixing frequency	Maximum temperature
SmartBlock <i>0.5 mL</i>	Tube volume 0.5 mL	2 000 rpm	100 °C
SmartBlock <i>1.5 mL</i>	Tube volume 1.5 mL	2 000 rpm	100 °C
SmartBlock <i>2.0 mL</i>	Tube volume 2.0 mL	2 000 rpm	100 °C
SmartBlock <i>5.0 mL</i>	Tube volume 5.0 mL	1 000 rpm	100 °C
SmartBlock <i>12 mm</i>	Tubes with a diameter of 11 mm to 11.9 mm	2 000 rpm	110 °C*
SmartBlock <i>cryo</i>	Cryotubes	2 000 rpm	110 °C*
SmartBlock <i>15 mL</i>	Conical tubes volume 15 mL	1 000 rpm	100 °C
SmartBlock <i>50 mL</i>	Conical tubes volume 50 mL	1 000 rpm	100 °C
SmartBlock <i>plates</i>	Microplates	3 000 rpm	100 °C
	Deepwell plates	2 000 rpm	< 80 °C
		1 000 rpm	> 80 °C
SmartBlock <i>PCR 96</i>	96-well PCR plates, PCR tubes 0.2 mL	2 000 rpm	100 °C
SmartBlock <i>PCR 384</i>	384-well PCR plates	3 000 rpm	100 °C

* Only in combination with ThermoStat C.

3 Safety

3.1 Intended use



Thermoblocks for the ThermoMixer C and ThermoStat C (SmartBlocks) devices are intended for use in a molecular biology laboratory.

The thermoblocks are used to hold tubes and plates during sample preparation and during temperature control and mixing of samples.

The thermoblocks are intended exclusively for indoor use. All country-specific safety requirements for operating electrical equipment in the laboratory must be observed. Only use Eppendorf accessories or accessories recommended by Eppendorf.

The thermoblocks must only be operated by appropriately qualified and instructed personnel.

3.2 Warning signs on the device

Representation	Meaning	Location
	Risk of burns from hot surfaces.	On the thermoblock
	Caution! Risk of injury from moving parts. ▶ Observe the operating manual.	On the thermoblock

4 Installation and operation

4.1 Installing the thermoblock



WARNING! Personal injury or material damage due to chemically or mechanically damaged thermoblocks.

- ▶ Do not use thermoblocks that show signs of corrosion or mechanical damage.
- ▶ Regularly check the condition of the thermoblocks.



WARNING! Contamination due to opening seals of consumables.

In the following cases, the seals of tubes can spring open. Sample material can escape.

- high vapor pressure of the content
- improperly sealed cover
- damaged sealing lip
- improperly fastened foil
- ▶ Always check that consumables have been sealed tightly before use.

When you attach the thermoblock, the device automatically recognizes the mounted thermoblock. The ThermoMixer C limits the mixing frequency to the maximum value for the thermoblock being used. The ThermoStat C limits the temperature to the maximum value for the thermoblock being used.

4.1.1 Attaching the thermoblock

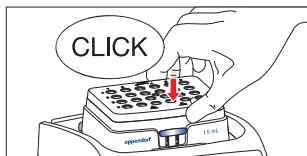

1. First only attach the rear edge of the thermoblock. The writing must face to the front.
2. Push the front edge of the thermoblock down.
 - The thermoblock audibly engages.
 - The display shows the name of the thermoblock.

4.1.2 Removing the thermoblock



WARNING! Risk of burns from hot surfaces.

The thermoblock and the heating/cooling plate can be very hot after heating and cause burns.

- ▶ Allow the heated thermoblock and heating/cooling plate to cool down completely before removing the thermoblock.

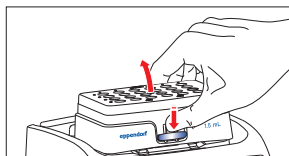

1. To unlock the thermoblock, press the lever at the front of the thermoblock down.
2. Lift the front edge so that the thermoblock is tilted backwards.
3. Remove the thermoblock upwards.

4.2 Inserting tubes and plates



WARNING! Risk of injury due to incorrect consumables.

- Glass tubes can smash.
 - ▶ Only use the thermoblocks with the consumables designed for them.
 - ▶ Never use tubes made of glass or other fragile material.
-



NOTICE! Damage to plates due to too high temperatures.

- Polystyrene microplates melt at temperatures above 70 °C.
Polypropylene deepwell plates deform at temperatures above 80 °C.
Deformed plates can become loose in the thermoblock.
- ▶ Only heat microplates up to 70 °C.
-



NOTICE! Material change of consumables due to extreme temperatures.

- Extreme temperatures (e.g., refrigeration, autoclaving) affect consumables' material. The mechanical strength or dimensions and shape of the consumables may change.
- ▶ Use consumables that are suitable for the selected temperature range or selected procedure.
-



- ▶ When inserting microplates, make sure that the height sensor is not covered.
 - ▶ Take care that the height sensor does not get contaminated.
-

- ▶ Place the suitable thermoblock on the device (see *Attaching the thermoblock on p. 5*).

Inserting the plate

- ▶ Insert the plate with the back edge first. Then press it down at the front.

Inserting tubes

- ▶ Insert the tubes completely into the bores of the thermoblock.

SmartBlock *plates*, SmartBlock *PCR 96* or SmartBlock *PCR 384*:

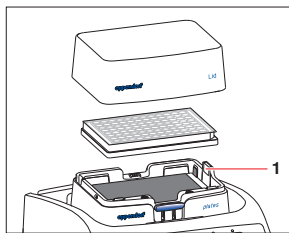

1 height sensor

- ▶ To ensure uniform temperature control, place the lid on the thermoblock.

5 Maintenance

5.1 Cleaning



NOTICE! Damage from the use of aggressive chemicals.

- ▶ Do not use any aggressive chemicals on the device or its accessories, such as strong and weak bases, strong acids, acetone, formaldehyde, halogenated hydrocarbons or phenol.
- ▶ If the device becomes contaminated with aggressive chemicals, clean it immediately with a mild cleaning agent.



NOTICE! Corrosion from aggressive cleaning agents and disinfectants.

- ▶ Do not use corrosive cleaning agents, aggressive solvents or abrasive polishes.

Auxiliary equipment

- Lint-free cloth
- Mild, soap-based lab cleaner
- Dist. water

Clean the thermoblock immediately if sample fluid enters the bore holes or comes into contact with the surfaces.

1. Clean with a mild soap solution.
2. Wipe off the soap solution with dist. water.
3. Dry the cleaned thermoblock.

5.2 Disinfection/decontamination



WARNING! Risk to health from contaminated accessories.

1. Follow the instructions in the decontamination certificate. You can find them as a PDF file on our webpage (www.eppendorf.com/decontamination).
2. Decontaminate all the parts you want to dispatch.
3. Include the fully completed decontamination certificate for returned goods in the package.

- ▶ Select a disinfection method complying with the statutory rules and regulations for your area of application. Use e.g. alcohol (ethanol, isopropanol) or alcohol-containing disinfectants.

6 Transport, storage and disposal

6.1 Disposal

In case the product is to be disposed of, the relevant legal regulations are to be observed.

Information on the disposal of electrical and electronic devices in the European Community:

Within the European Community, the disposal of electrical devices is regulated by national regulations based on EU Directive 2002/96/EC pertaining to waste electrical and electronic equipment (WEEE).

According to these regulations, any devices supplied after August 13, 2005, in the business-to-business sphere, to which this product is assigned, may no longer be disposed of in municipal or domestic waste. To document this, they have been marked with the following identification:



Because disposal regulations may differ from one country to another within the EU, please contact your supplier if necessary.

In Germany, this is mandatory from March 23, 2006. From this date, the manufacturer has to offer a suitable method of return for all devices supplied after August 13, 2005. For all devices supplied before August 13, 2005, the last user is responsible for the correct disposal.

7 Ordering information

7.1 Device and accessories

Order no. (international)	Order No. (North America)	Description
5382 000.015 –	– 5382000023	ThermoMixer C basic device without thermoblock 220 V – 240 V 100 V – 130 V
5383 000.019 –	– 5383000027	ThermoStat C basic device without thermoblock 220 V – 240 V 100 V – 130 V
5308 000.003	5308000003	ThermoTop with condens.protect technology
5361 000.031	5361000031	SmartBlock 0.5 mL Thermoblock for 24 tubes 0.5 mL
5360 000.038	5360000038	SmartBlock 1.5 mL Thermoblock for 24 tubes 1.5 mL
5362 000.035	5362000035	SmartBlock 2.0 mL Thermoblock for 24 tubes 2.0 mL
5309 000.007	5309000007	SmartBlock 5.0 mL Thermoblock for 8 tubes 5.0 mL
5366 000.021	5366000021	SmartBlock 15 mL Thermoblock for 8 conical tubes 15 mL
5365 000.028	5365000028	SmartBlock 50 mL Thermoblock for 4 conical tubes 50 mL
5364 000.024	5364000024	SmartBlock 12 mm Thermoblock for 24 tubes diameter 11 mm – 11.9 mm, height 34 mm – 76 mm
5367 000.025	5367000025	SmartBlock cryo Thermoblock for 24 Cryo tubes 1.5 mL – 2 mL, diameter max. 12,5 mm, all base shapes

Order no. (international)	Order No. (North America)	Description
5363 000.039	5363000039	SmartBlock plates Thermoblock for microplates and deepwell plates incl. Lid
5306 000.006	5306000006	SmartBlock PCR 96 Thermoblock for PCR plates 96 incl. Lid
5307 000.000	5307000000	SmartBlock PCR 384 Thermoblock for PCR plates 384 incl. Lid





Evaluate your operating manual

www.eppendorf.com/manualfeedback

eppendorf

Your local distributor: www.eppendorf.com/worldwide

Eppendorf AG · 22331 Hamburg · Germany · Tel: +49 40 53801-0 · Fax: +49 40 538 01-556 · E-mail: eppendorf@eppendorf.com
Eppendorf North America, Inc. · 102 Motor Parkway · Hauppauge, N.Y. 11788-5178 · USA
Tel: +1 516 334 7500 · Toll free phone: +1 800-645-3050 · Fax: +1 516 334 7506 · E-mail: info@eppendorf.com

Application Support Europe: Tel: +49 1803 666 789 (Preis je nach Tarif im Ausland; 9 ct/min aus dem dt. Festnetz; Mobilfunkhöchstpreis 42 ct/min)
support@eppendorf.com

North America: Tel: +1 800 645 3050 · E-mail: techserv@eppendorf.com

Asia Pacific: Tel: +60 3 8023 6869 · E-mail: support_asiapacific@eppendorf.com